

Conference Program

August 2-4, 2016
Okinawa, Japan

APICENS

Asia-Pacific International Congress on Engineering &
Natural Sciences

IBCELC

International Biotechnology, Chemical Engineering
and Life Science Conference

ISBSS

International Symposium on Business and Social
Sciences

ISLLE

International Symposium on Language, Linguistics,
Literature and Education

APICENS

Asia-Pacific International Congress on Engineering & Natural Sciences

ISBN 978-986-89298-2-1

IBCELC

International Biotechnology, Chemical Engineering and Life Science Conference

ISBN 978-986-90263-9-0

ISBSS

International Symposium on Business and Social Sciences

ISBN 978-986-87417-9-9

ISLLE

International Symposium on Language, Linguistics, Literature and Education

ISBN 978-986-89844-7-9

Content

General Information for Participants	3
International Committees.....	5
International Committee of APICENS.....	5
International Committee of IBCELC.....	7
International Committee of ISBSS.....	8
International Committee of ISLLE.....	10
Special Thanks to Session Chairs.....	11
Conference Venue Information	12
Conference Schedule.....	13
Nature Sciences Keynote Speech	16
Social Sciences Keynote Speech	18
Oral Sessions.....	19
Biomedical Engineering / Biotechnology Engineering.....	19
Language (1)	21
Education (1)	23
Education (2)	24
Life Science / Natural Science	25
Communication / Sociology / Politics / Psychology	27
Literature / Linguistics (1)	28
Mechanical Engineering/ Civil Engineering / Chemical Engineering.....	29
Education (3) / Linguistics (2) / Language (2)	31
Material Science and Engineering.....	33
Finance.....	35
Electrical and Electronic Engineering.....	36
Management.....	37
Business.....	39
Poster Session (1)	40
Biomedical Engineering / Biotechnology Engineering / Chemical Engineering / Life Science.....	40
Poster Session (2)	45
Civil Engineering / Computer and Information Sciences / Electrical and Electronic Engineering / Material Science and Engineering / Business / Economics / Finance / Management.....	45
Poster Session (3)	49
Communication / Education / Sociology / Psychology / Politics	49

General Information for Participants

■ **Registration**

The registration desk will be situated on the **3rd floor** at the **Loisir Hotel Naha** during the following time:

08:30-17:30 Wednesday, August 3, 2016

08:30-17:00 Thursday, August 4, 2016

■ **Organizer**



Higher Education Forum (HEF)

Tel: + 886 2 2740 1498 | www.prohef.org



■ **A Polite Request to All Participants**

Participants are requested to arrive in a timely fashion for all addresses. Presenters are reminded that the time slots should be divided fairly and equally by the number of presentations, and that they should not overrun. The session chair is asked to assume this timekeeping role and to summarize key issues in each topic.



Sandals or Slippers



Tank Top



Shorts

■ **Certificate**

Certificate of Presentation or Certificate of Attendance

A certificate of attendance includes participant's name and affiliation, certifying the participation in the conference. A certificate of presentation indicates a presenter's name, affiliation and the paper title that is presented in the scheduled session.

Certificate Distribution

Oral presenters will receive a certificate of presentation from the session chair after their presentations or at the end of the session. Poster presenters will receive a certificate of presentation from the conference staff at the end of their poster session.

The certificate of presentation will not be issued, either at or after the conference, to authors whose papers are registered but not presented. Instead, the certificate of attendance will be provided after the conference.

■ Preparation for Oral Presentations

All presentation rooms are equipped with a screen, an LCD projector, and a laptop computer installed with Microsoft PowerPoint. You will be able to insert your USB flash drive into the computer and double check your file in PowerPoint. We recommend you to bring two copies of the file in case that one fails. You may also connect your own laptop to the provided projector; however please ensure you have the requisite connector.

Preparation for Poster Presentation

Materials Provided by the Conference Organizer:

1. X-frame display & base fabric canvases (60cm×160cm)
2. Adhesive tapes or binder clips

Materials Prepared by the Presenters:

3. Home-made poster(s)
4. Material: not limited, can be posted on the canvases
5. Recommended poster size: 60cm*160cm



<p>A 60cm*160cm poster illustrates the research findings.</p>	<ol style="list-style-type: none"> 1. Wider than 60cm (left) 2. Copy of PowerPoint slides in A4 papers (right)

International Committees

International Committee of APICENS

S. Ahmed John, Jamal Mohamed College, India
Ashley Love, A.T. Still University, USA
Asmida Ismail, University Technology Mara, Malaysia
Thippayarat Chahomchuen, Kasetsart University, Thailand
Don Liu, Louisiana University, USA
Bayani U. Almacen, Philippine Association of Maritime Training Centers, Philippines
Jian-Hong Chen, Chung Shan Medical University, Taiwan
Onder Turan, Anadolu University, Turkey
Hairul Azman Roslan, Universiti Malaysia Sarawak, Malaysia
Hiroschi Uechi, Osaka Gakuin University, Japan
Wong Hai Ming, The University of Hong Kong, Hong Kong
Ching-An Peng, University of Idaho, USA
Chee Fah Wong, Universiti Pendidikan Sultan Idris, MALAYSIA
Christoph Lindenberger, Friedrich - Alexander University, Germany
Chia-Ray Lin, Academia Sinica, Taiwan
Fatchiyah M.Kes., Universitas Brawijaya, Indonesia
Kuan-Chen Cheng, National Taiwan University, Taiwan
Rainer Buchholz, Friedrich-Alexander University, Germany
Hamed M El-Shora, Mansoura University, Egypt
Sittisak Uparivong, Khon Kaen University, Thailand
Asif Mahmood, King Saud University, Riyadh, Saudi Arabia
Saji Baby, Kuwait University, KUWAIT
Shen-Long Tsai, National Taiwan University of Science and Technology, Taiwan
Suresh B. Gholve, Nagpur University, India
M. Chandra Sekhar, National Institute of Technology, India
Chee-Ming Chan, Universiti Tun Hussein Onn Malaysia, Malaysia
Chi-Ming Lai, National Cheng-Kung University, Taiwan
Edward J. Smaglik, Northern Arizona University, USA
Ransinchung R.N.(Ranjan), Indian Institute of Technology, India
Hasmawi Bin Khalid, University Teknologi Mara, Malaysia
Roslan Zainal Abidin, Infrastructure University Kuala Lumpur, Malaysia
Baolin Wang, University of Western Sydney, Australia
Hung-Yuan Chung, National Central University, Taiwan
Phongsak Phakamach, North Eastern University, Thailand

Chang Ping-Chuan, Kun Shan University, Taiwan
P.Sanjeevikumar, University of Bologna, India
Alexander M. Korsunsky, Trinity College, Oxford, UK
Michiko Miyamoto, Akita Prefectural University, Japan
Cheuk-Ming Mak, The Hong Kong Polytechnic University, Hong Kong
Lai Mun Kou, SEDI University, Malaysia
William L. Baker, Indiana State University, USA
Anthony D. Johnson, Seoul National University of Science & Technology, UK
Chil Chyuan Kuo, Ming Chi University, Taiwan
Sudhir C.V., Caledonian College of Engineering, Oman
Abhishek Shukla, R.D. Engineering College Technical Campus, Ghaziabad, India
Ahmad Zahedi, James Cook University, Australia
Jeril Kuriakose, Manipal University, India
Hanmin Jung , Korea Institute of Science and Technology Information (KISTI) , Korea
Jivika Govil, Zion Bancorporation , India
Hyoungseop Kim, Kyushu Insititute of Techonogy, Japan
Farhad Memarzadeh, National Institutes of Health, USA
Pei-Jeng Kuo, National Chengchi University, Taiwan
Abdelmalik Serbout, University of physical and sports activities Djelfa Algeria, Algeria

International Committee of IBCELC

Ching-An Peng, University of Idaho, USA

Chee Fah Wong, Universiti Pendidikan Sultan Idris, Malaysia

Christoph Lindenberger, Friedrich-Alexander University , Germany

Chia-Ray Lin, Academia Sinica, Taiwan

Fatchiyah M.Kes., Universitas Brawijaya, Indonesia

Kuan-Chen Cheng, National Taiwan University, Taiwan

Rainer Buchholz, Friedrich-Alexander University, Germany

Hamed M El-Shora, Mansoura University, Egypt

Sittisak Uparivong, Khon Kaen University, Thailand

Asif Mahmood, King Saud University, Riyadh, Saudi Arabia

Saji Baby, Kuwait University, Kuwait

Shen-Long Tsai, National Taiwan University of Science and Technology, Taiwan

Suresh B. Gholve, Nagpur University, India

International Committee of ISBSS

Brian Hunt, Mahidol University , Thailand
Cheng-Min Feng, National Chiao Tung University, Taiwan
Donald L. Amoroso, Auburn University at Montgomery, USA
David Yoon, Universitaire Léonard de Vinci, France
Maria Cristina M. De los Santos, Kyungdong University-Global Campus, South Korea
T.S.Devaraja, University of Mysore, Hemagangothri Campus, India
Amol Gore, Università degli Studi di Padova, Thailand
Badar Alam Iqbal Aligarh Muslim University, India
Edward Hwang, Chung Hua University, Taiwan
Irene Guatno Toribio, Philippine Christian University, Philippines
José G. Vargas-Hernández, Universidad de Guadalajara, México
Kaedsiri Jaroenwisan, Silpakorn Univesity, Thailand
Karen Miranda Fernandez, Imus Institute, Phillippines
Kazuaki Maeda Chubu Univeristy, Japan
B. Suresh Lal, Kakatiya University, India
N. S. Ravishankar, Axis Bank, India
Ramayah Thurasamy, Universiti Sains Malaysia, Malaysia
Shiney Chib, Datta Meghe Institute of Management Studies, India
Kim Sangho, Ritsumeikan Asia Pacific University, Japan
Tan Khay Boon, SIM Global Education, Singapore
Micheal Kon, Aletheia University, Taiwan
Aziz Bin Ahmad University Malaysia Terengganu, Malaysia
Atefeh Ferdosipour, Azad University (East Tehran Branch), Iran
Azilawati, Nanyang Technological University, Singapore, Singapore
Bayram Akarsu, Erciyes University, Turkey
Bor-Tyng Wang, Feng Chia University, Taiwan
Donghun Lee, Sungkyunkwan University, South Korea
Cathine G. Scott, Morris College in Sumter, USA
Prasong Tanpichai, Kasetsart University, Thailand
Hamzeh Dodeen, United Arab Emirates University, UAE
Sadiq Abdulwahed Ahmed Ismail, United Arab Emirates University, UAE
Kim, Deok Man, Baekseok University, South Korea
Adeeb Jarrah, United Arab Emirates University, UAE
Wei-Cheng(Joseph) Mau Wichita State University, USA
Kanokphon ChantananarungpakSrinakharinwirot University, Thailand
Vijayaletchumy Subramaniam, Universitas Putra Malaysia, Malaysia
Linda Oshita, University of Hwaii, USA

Michael Kao, Chang Gung University, Taiwan
Mingchu (Neal) Luo , Emporia State University, USA
Theeraphab Phetmalaikul, Srinakharinwirot University, Thailand
Ricky Yuk-Kwan Ng, Vocational Training Council, Hong Kong, Hong Kong
Kim , Kyung Hee, Mokpo National University, South Korea
Shujen Lee Chang, Asia University, Taiwan
Sally dhruva' Stephenson, Frosterburg State University, USA
Ching-Yi Tien, I-Shou University, Taiwan
Reem Abed Almotaleb Abuiyada, Dhofar University, Palestine
David C. Donald, The Chinese University of Hong Kong, UK
Rotaru Ioan-Gheorghe, Timotheus Brethren Theological Insititute of Bucharest, Romania
Obydullah Al Marjuk Independent University, Bangladesh Bangladesh
Gajendra Singh, Satyawati College, University of Delhi India
Shaik. Feroz Caledonian College of Engineering, Oman
Intan Soliha Binti Ibrahim Universiti Malaysia Sabah, Malaysia
Jamie Halsall University of Huddersfield, UK
John Christian S. Jardin Palawan State University, Philippines
Dharam Vir Mahajan, CCS University, Meerut, India
Darshan kaur Narang, University of Rajasthan, Jaipur, India
Ronald Griffin, Florida Agricultural & Mechanical University, USA

International Committee of ISLLE

Aziz Bin Ahmad, University Malaysia Terengganu Malaysia
Atefeh Ferdosipour, Azad University (East Tehran Branch), Iran
Azilawati, Nanyang Technological University, Singapore
Bayram Akarsu, Erciyes University, Turkey
Bor-Tyng Wang, Feng Chia University, Taiwan
Donghun Lee , Sungkyunkwan University, South Korea
Cathine G. Scott, Morris College in Sumter, USA
Prasong Tanpichai, Kasetsart University, Thailand
Hamzeh Dodeen, United Arab Emirates University, UAE
Sadiq Abdulwahed Ahmed Ismail , United Arab Emirates University, UAE
Kim, Deok Man, Baekseok University, South Korea
Adeeb Jarrah , United Arab Emirates University, UAE
Wei-Cheng(Joseph) Mau , Wichita State University, USA
Kanokphon Chantananurpak , Srinakharinwirot University, Thailand
Vijayaletchumy Subramaniam , Universitas Putra Malaysia, Malaysia
Linda Oshita , University of Hawaii, USA
Michael KaoChang , Gung University, Taiwan
Mingchu (Neal) Luo, Emporia State University, USA
Theeraphab Phetmalaikul , Srinakharinwirot University, Thailand
Ricky Yuk-Kwan Ng , Vocational Training Council, Hong Kong
Kim, Kyung Hee , Mokpo National University, South Korea
Shujen Lee Chang , Asia University, Taiwan
Sally dhruva' Stephenson , Frosterburg State University, USA
Ching-Yi Tien, I-Shou University, Taiwan

Special Thanks to Session Chairs

Shu-Ping Lin	National Chung Hsing University
Andrea Nolan	Deakin University
Nobuhiko Takada	Kanazawa Gakuin University
Charles Bingham	Simon Fraser University
Takashi Kamada	University of Malaysia Sabah
Momoyo K. Shibuya	Saitama University
Nadir Baloglan Oglu Memmedli	National Academy of Sciences of Azerbaijan
Tomohiro Nakano	Tokai University
Tomoyasu Akiyama	Bunkyo University
Yoshitake Nishi	Tokai University
Darius Chan	The Chinese University of Hong Kong
Hung-Yuan Chung	National Central University
Peng-Ting Chen	National Cheng Kung University
Chia-Hui Huang	National Taipei University of Business

Conference Venue Information

Loisir Hotel Naha

ロワジールホテル 那覇

www.loisir-naha.com

〒900-0036 沖縄県那覇市西 3-2-1

TEL : 098-868-2222 / FAX : 098-860-2000

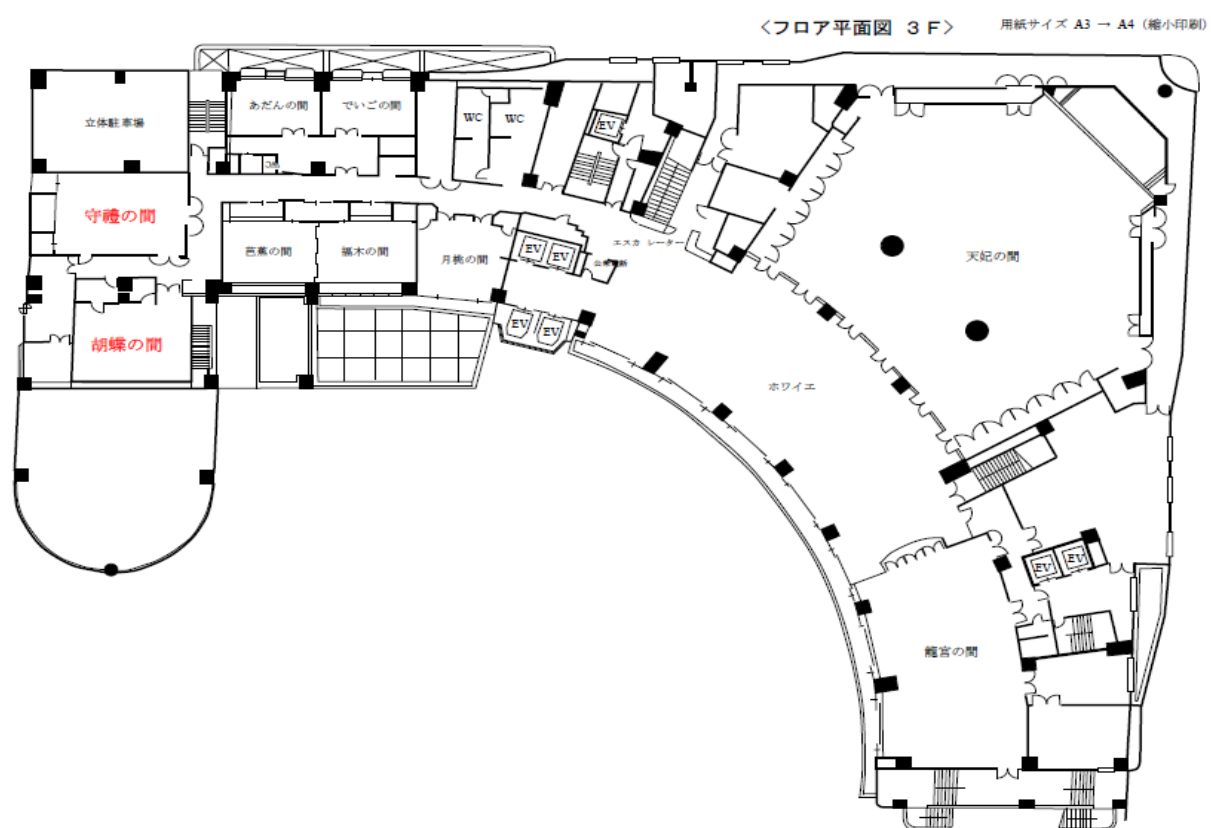

Conference Schedule

Tuesday, August 2, 2016

Executive Committee Meeting (Executive Committee Only)

Wednesday, August 3, 2016

Oral Presentation

Loisir Hotel Naha (3rd Floor)

Time	Schedule	Venue
08:30-17:00	Registration	Foyer Area
09:00-11:00	Biomedical Engineering / Biotechnology Engineering	守禮の間 (SHUREI no MA)
	Language (1)	胡蝶の間 (KOCHO no MA)
11:00-11:20	Break & Networking	Foyer Area
11:20-12:10	<u>Nature Science Keynote Speech</u> Dr. Kwun Nam HUI University of Macau <u>Topic: Engineering Spinel Materials for High Energy Density Supercapacitor</u>	守禮の間 (SHUREI no MA)
	<u>Social Science Keynote Speech</u> Dr. Stacey Vye Saitama University <u>Topic: Creativity, Collaborative Autonomy, and Innovation in Education</u>	胡蝶の間 (KOCHO no MA)
12:00-13:00	Lunch Time	
13:00-14:30	Education (1)	胡蝶の間 (KOCHO no MA)
14:30-14:45	Break & Networking	Foyer Area
14:45-16:15	Education (2)	胡蝶の間 (KOCHO no MA)
16:15-16:30	Break & Networking	Foyer Area
16:30-18:00	Life Science / Natural Science	胡蝶の間 (KOCHO no MA)

Wednesday, August 3, 2016

Poster Presentation

Loisir Hotel Naha (3rd Floor) 守禮の間 (SHUREI no MA)

Time	Schedule
13:40-14:40	Poster Sessions (1) Biomedical Engineering / Biotechnology Engineering / Chemical Engineering / Life Science
15:00-16:00	Poster Sessions (2) Civil Engineering / Computer and Information Sciences / Electrical and Electronic Engineering / Material Science and Engineering / Business / Economics / Finance / Management
16:20-17:20	Poster Sessions (3) Communication / Education / Sociology / Psychology / Politics

Thursday, August 4, 2016		
Oral Presentation		
Loisir Hotel Naha (3rd Floor)		
Time	Schedule	Venue
08:30-16:30	Registration	Foyer Area
08:45-10:15	Communication / Sociology / Politics / Psychology	守禮の間 (SHUREI no MA)
	Literature / Linguistics (1)	胡蝶の間 (KOCHO no MA)
10:15-10:30	Break & Networking	Foyer Area
10:30-12:00	Mechanical Engineering/ Civil Engineering / Chemical Engineering	守禮の間 (SHUREI no MA)
	Education (3) / Linguistics (2) / Language (2)	胡蝶の間 (KOCHO no MA)
12:00-13:00	Lunch Time	
13:00-14:30	Material Science and Engineering	守禮の間 (SHUREI no MA)
	Finance	胡蝶の間 (KOCHO no MA)
14:30-14:45	Break & Networking	Foyer Area
14:45-16:15	Electrical and Electronic Engineering	守禮の間 (SHUREI no MA)
	Management	胡蝶の間 (KOCHO no MA)
16:15-16:30	Break & Networking	Foyer Area
16:30-17:30	Business	胡蝶の間 (KOCHO no MA)

Nature Sciences Keynote Speech

守禮の間 (SHUREI no MA), 3rd Floor

11:20 - 12:10, Wednesday, August 3, 2016

Topic: Engineering Spinel Materials for High Energy Density Supercapacitor

Dr. Kwun Nam HUI
Faculty of Science and Technology
University of Macau
Avenida da Universidade, Taipa,
Macau, China



Abstract

The continuous increase in energy demand has significantly stimulated a considerable number of studies for energy storage and conversion applications. Electrochemical capacitors have attracted extensive attention because of their overall advantages of bridging the gap between batteries and conventional capacitors. However, most commercial supercapacitors still suffer from low energy density (10 Wh kg^{-1}), high cost, and bulky issues in certain consumer products, such as laptops, electronic digital cameras, and mobile phones. Therefore, developing an advanced electrochemical capacitor with advantages of high energy density, lightweight, and low cost while maintaining intrinsic high power density and long cycle life is imperative.

In this talk, the speaker presents his recent work in the development and applications of nanostructured spinel ($A_xB_3-xO_4$) materials for SCs. First, he describes how the synergistic effect of spinel/graphite paper hybrid as high performance binder-free supercapacitor electrode. Second, he illustrates how core-shell nanostructured electrodes can achieve high energy density at high current density as well as high rate capability of for applications in SCs by providing more electroactive sites for electrochemical reactions, facilitating the electrolyte ions access to the surface of active materials, reducing the ions diffusion paths, maintaining the structural integrity of the materials during charge/discharge process, and improving the utilization rate of electrode. Third, he demonstrates the stacking concept as effective method of increasing mass loading of active materials without sacrificing the geometry of the nanostructures for achieving a higher electrochemical performance.

This work was supported by the Science and Technology Development Fund from Macau SAR (FDCT-098/2015/A3)

Brief Introduction of Dr. Kwun Nam HUI

Dr. Kwun Nam HUI is an assistant professor at the Institute of Applied Physics and Materials Engineering, Faculty of Science and Technology, University of Macau, Macau SAR, China. He obtained his B.Sc. degree in Physics from the Hong Kong University of Science and Technology in 2003 and his M.Phil. and Ph.D. degrees in Electrical and Electronic Engineering from the University of Hong Kong in 2007 and 2009, respectively. He worked as a postdoctoral associate in 2009 at the Institute of Advanced Materials, Devices, and Nanotechnology, Rutgers, The State University of New Jersey. He contributed to the development of the ultrafast photonic crystal waveguide modulator for communication. He joined Pusan National University in the fall of 2009. Recently, he joined University of Macau in the fall of 2015. Thus far, he has conducted research in different areas related to energy and the environment, including Li-ion battery, supercapacitor, and electrode materials for direct methanol/direct hydrogen peroxide fuel cell, hydrogen production by methanol steam reforming, solid-state lighting, desiccant cooling, removal of volatile organic compounds in air, and wastewater treatment. His major contributions include the use of fluorescent nanospheres for proprietary white-light LEDs, design and implementation of proprietary vertically stacked polychromatic LED structure for color-tunable LEDs, first report of UV-stimulated emission from pivoted GaN-on Si microcavities, first demonstration of UV lasing of GaN nanopillar structure at room temperature, first demonstration of synergetic effects of MnO₂/graphene composite to improve catalytic ozonation of gaseous toluene, development of reusable catalyst chip for wastewater treatment, green method for synthesizing graphene, metal (oxide)/graphene composite for fuel cell applications, and production of hierarchical N-doped porous carbon from biowastes as electrode materials for supercapacitors. As principal investigator, he has managed 12 research projects with a total research grant of USD 0.8 million. His research has led to one US patent, eleven Korea patents, four review papers, three book chapters, >100 peer-reviewed SCI journal papers, and >50 conference papers. He has served as lead guest editor/guest editor/member of the editorial board of a number of journals, such as Frontier, Reviews in Advanced Sciences and Engineering, Journal of Nanomaterials, Current Nanoscience, The Scientific World Journal, and Scientific Journals International. He was in the organizing committee of the 4th Conference on New Energy and Sustainable Development. His current research focuses on synthesis of hierarchical carbon/graphene materials as well as on the development of 3D hierarchical layered double hydroxide materials as advanced electrode materials for energy storage and conversion applications.

Social Sciences Keynote Speech

胡蝶の間 (KOCHO no MA), 3rd Floor

11:20 - 12:10, Wednesday, August 3, 2016

Topic: Creativity, Collaborative Autonomy, and Innovation in Education

Dr. Stacey Vye

Associate Professor

Center for English Education and Development

Saitama University



Abstract

All too often in academia, teacher/researchers can be isolated in their environments because support and faculty development are not readily available. Moreover, in such situations, these teachers/researchers may also experience fear of repercussion if they do not complete large undertakings in a well-timed manner. This feeling of being under continuous pressure leads to a fear of failing, which can undermine the creative force that is essential for innovative learning environments. Therefore, in this workshop, participants will explore ways of developing and sustaining collaborative autonomous support groups where creativity and innovation can flourish for effective change in a variety of academic settings.

Brief Introduction of Dr. Stacey Vye

Stacey Vye is an associate professor at Saitama University at the Center for English Education and Development (CEED) and a lecturer at New York University's School of Continuing and Professional Studies American Language Institute, both in Japan. She also is doctoral candidate at the USC Rossier School of Education in the Organizational Change and Leadership EdD program. Her research interests focus on exploring learner and teacher reflection, and learner and teacher autonomy in language education, including the connections between both capacities.

Biomedical Engineering / Biotechnology Engineering

Wednesday, August 3, 2016 09:00-11:00

守禮の間

(SHUREI no MA)

Session Chair: *Shu-Ping Lin*

APICENS-1440

The Impact of Uneven Saline Distribution on Thermal Lesion during Radiofrequency Ablation Treatments

Huang-Wen Huang | *Tamkang University*

IBCELC-28914

Synthesis of Novel Biocompatible Photo-Polymers for 3D Printing

Yu-Chi Su | *National Taiwan University of Science Technology*

Min-Huei Chiou | *National Taiwan University of Science Technology*

Ming-Hua Ho | *National Taiwan University of Science Technology*

IBCELC-28920

Biocompatible Study of Surface Modification of Anodized Nanostructure on Selective-Laser-Melting Produced Ti6Al4V

Yen-Ting Ou | *National Chung Hsing University*

Chia-Wei Huang | *National Chung Hsing University*

Shu-Ping Lin | *National Chung Hsing University*

IBCELC-28923

Impedimetric Detection of Dopamine Using Reduced Graphene-Oxide-Based Biosensors

Jhong-Yi Ciou | *National Chung Hsing University*

Tung-Yen Lai | *National Nano Device Laboratories*

Tsung-Wu Lin | *Tung Hai University*

Shu-Ping Lin | *National Chung Hsing University*

IBCELC-28924

Efficient Acetic Acid Production from Nipa Sap by Fed-Batch Fermentation Using Immobilized *Moorella thermoacetica* (f. *Clostridium thermoaceticum*)

Dung Van Nguyen | *Kyoto University*

Harifara Rabemanolontsoa | *Kyoto University*

Shiro Saka | *Kyoto University*

IBCELC-28929

Investigation into the Combined Effects of Small Chemical and Nanostructure on Biocompatibility of Titanium and Its Alloy

Shu-Ping Lin | *National Chung Hsing University*

Yen-Ting Ou | *National Chung Hsing University*

Chia-Wei Huang | *National Chung Hsing University*

IBCELC-28932

In Vitro Three-Dimensional Lymphatic Endothelials Growth for Evaluation of Hyperthermia Effect

Pei Chien Tseng | *National Chung Hsing University*

Shu-Yen Huang | *National Chung Hsing University*

Shu-Ping Lin | *National Chung Hsing University*

Language (1)

Wednesday, August 3 , 2016 09:00-11:00

胡蝶の間

(KOCHO no MA)

Session Chair: *Andrea Nolan*

ISLLE-1337

Language Acquisition Database: User Interface Needs Analysis

David Wright | *Tokai University*

Hiroshi Nakagawa | *Tokai University*

ISLLE-1341

The Profile of Non-Native Teacher's Oral Skills: A Study Carried out in Brasília, the Capital of Brazil

Joana Grant | *Cooplem Idiomas*

ISLLE-1329

Digital Editing Studio: The Roles of Multimodal Literacy and Interaction for TEFL University Learners

Chia-Yi Li | *Southern Taiwan University of Science and Technology*

ISLLE-1357

Improving EFL Learners' Quasiacademic Presentation Performances through "Cognitive Framed Logic Approach"

Wen-Pi Chao | *Tamkang University*

ISLLE-1360

Bilingual Education of Hmong Ethnic (Case Study in Lao Chai Commune, Sapa District, Lao Cai Province, Viet Nam)

Le Thi Thu | *National Cheng Kung University*

ISLLE-1361

Research into Dialectal Variation in Vietnamese of Migrant Workers: A Case Study of Dat Cuoc Industrial Zone, Binh Duong Province, Vietnam

Dang Thi Kieu Oanh | *National Cheng Kung University*

ISLLE-1330

Exploring Teachers Talk during Oral Language Teaching Interactions from Both Sides of the School Fence

Andrea Nolan | *Deakin University*

Louise Paatsch | *Deakin University*

Janet Scull | *Monash University*

Education (1)

Wednesday, August 3, 2016 13:00-14:30

胡蝶の間
(KOCHO no MA)

Session Chair: *Nobuhiko Takada*

ISBSS-6058

How Far Figurative Design Can Go: Defamiliarized Expressions by Operation

Shih-Hung Cheng | *National Yunlin University of Science and Technology*

Tzu-Ching Hsu | *National Chiao Tung University*

Ming-Huang Lin | *National Chiao Tung University*

ISBSS-6088

The Expression of the Traditional Craft Article of Ishikawa Prefecture by Projection Mapping

Issei Yoshida | *Kanazawa Gakuin University*

Nobuhiko Takada | *Kanazawa Gakuin University*

ISBSS-6095

An Educational Study for Applying Generative Design Using a Computer Mouse Design as an Example

Lin-Chien Lee | *National Chiao Tung University*

Ming-Huang Lin | *National Chiao Tung University*

ISBSS-6115

Comparative Study of Tablet and Laptop Devices for Business Game Practice

Takashi Tachino | *Shoin University*

Jaewook Kim | *Shoin University*

ISBSS-6947

A Study on Korean English Learners' Amplifier Acquisition

Jaewon Yang | *Pusan National University*

ISBSS-6084

An FLES Program that Impacted a Small Island

Huimei Grace Yang | *National Quemoy University*

Chungju Tim Fan | *National Quemoy University*

Education (2)

Wednesday, August 3 , 2016 14:45-16:15

胡蝶の間

(KOCHO no MA)

Session Chair: *Charles Bingham*

ISLLE-1348

Teaching Rhetoric Today: Ancient Exercises for Contemporary Citizens

Julie Dainville | *Université libre de Bruxelles*

Benoît Sans | *Université libre de Bruxelles*

ISLLE-1332

Learning to Teach through an Indigenous Lens

Eunice Tang | *The Chinese University of Hong Kong*

Eddy K.W. Li | *University of Cambridge*

ISLLE-1376

Education as an Art Form

Charles Bingham | *Simon Fraser University*

ISLLE-1372

Representation of Ethnic and Religious Minorities in Textbooks: Promotion of Multiculturalism in History Curriculum

Liz Jackson | *University of Hong Kong*

ISLLE-1339

Action Research: Engaging Readers

Grace P. Wilkins | *University of Southern California*

ISLLE-1386

A Longitudinal Picture of English Enhancement Support in Hong Kong in 2016

Barley S. Y. Mak | *The Chinese University of Hong Kong*

Life Science / Natural Science

Wednesday, August 3, 2016 16:30-18:00

胡蝶の間

(KOCHO no MA)

Session Chair: *Prof. Takashi Kamada*

IBCELC-28907

Deciphering and Manipulating Natural Product Biosynthetic Gene Clusters by Bioinformatics and Functional Recombinations

Hsien-Tai Chiu | *National Cheng Kung University*

IBCELC-28913

Novel Anti-Bacterial Halogenated Tricyclic Sesquiterpenes from Bornean *Laurencia majuscula*

Takashi Kamada | *University of Malaysia Sabah*

Chin-Soon Phan | *University of Malaysia Sabah*

Charles Santhanaraju Vairappan | *University of Malaysia Sabah*

IBCELC-28946

Effects of Photoperiod on Production Performances and Reproductive Development of Female Betong Chicken (*Gallus domesticus*)

Kruan Buakeeree | *Songkhla Rajabhat University,*

Piyanan Nualhnuplong | *Songkhla Rajabhat University,*

APICENS-1418

Anti-Bacterial Diterpenes from Bornean Soft Corals *Sinularia flexibilis*

Takashi Kamada | *University of Malaysia Sabah*

Wei-Teng Wong | *University of Malaysia Sabah*

Chin-Soon Phan | *University of Malaysia Sabah*

Charles Santhanaraju Vairappan | *University of Malaysia Sabah*

APICENS-1449

Pot-Pollen is the Bee Pollen Stored by Meliponini: *Tetragonisca angustula*, Mérida-Venezuela and Sucumbíos-Ecuador

Patricia Vit | *Universidad de Los Andes*

APICENS-1413

A Crowdsourcing Mobile Game Used for Biomedical Named-Entity Recognition

Tien-Hao Chang | *National Cheng Kung University*

Yen-Lin Huang | *National Cheng Kung University*

APICENS-1486

A Preliminary Life Cycle Assessment (LCA) of Mango Production in Taiwan

Geoff M. Nicki | *National Dong Hwa University*

Ming C. Su | *National Dong Hwa University*

Chin H. Chang | Tainan District Agricultural Research and Extension Station, Council of Agriculture

Communication / Sociology / Politics / Psychology

Thursday, August 4 , 2016

08:45-10:15

守禮の間

(SHUREI no MA)

Session Chair: *Momoyo K. Shibuya*

ISBSS-6060

An Exploration of Mobile Application Icons Designing in Relation to the Visual Perception of Senior Consumers

Yi-Lin Yu | *Fu Jen Catholic University*

ISBSS-6078

Use of Facebook in Media Law & Ethics: A Descriptive Study

Gilbert D. Martinez | *Texas State University*

ISBSS-6120

Media Glorified the Violence Phenomenon - In the Cartoon "Bears Appear" as an Example

Ning Pan | *Fu Jen Catholic University*

ISBSS-6106

The Electronic Voting Admission Using a Cell Phone and Its Evaluation

Jaewook Kim | *Shoin University*

Takashi Tachino | *Shoin University*

ISBSS-6104

Analysis about the Relation between Aggression and Many Causes

Dain Kim | *Paul Math International School*

Daeryong Seo | *Paul Math International School*

ISBSS-6980

Subjective Well-Being and Social Networks in Urban Asia

Momoyo K. Shibuya | *Saitama University*

Literature / Linguistics (1)

Thursday, August 4 , 2016

08:45-10:15

胡蝶の間

(KOCHO no MA)

Session Chair: *Nadir Baloglan Oglu Memmedli*

ISLLE-1324

The Word against the Sword: Arabic Poetry in the Face of Despotism

Salaheldin Abdelaziz Elgebily | *Hankuk University of Foreign Studies*

ISLLE-1334

“Seven Valleys” in Sheikh Faridaddin Attar’s and Seyid Yahya Bakuvi’s Works

Nezaket Fatali Memmedli | *Institute of Manuscript*

ISLLE-1371

When Modern Lifestyle Threaten Urban Society in Nadira by Leila S. Chudori

Hiqma Nur Agustina | *University of Islamic Syekh Yusuf (UNIS) Tangerang*

ISLLE-1323

Politics, Language Policies and Language Perceptions in Multilingual Taiwan

Chin-Hui Chen | *National Pingtung University of Science and Technology*

Chang-Xin Chen | *National Pingtung University of Science and Technology*

Min-Hua Tsai | *National Pingtung University of Science and Technology*

Yen-Yu Yang | *National Pingtung University of Science and Technology*

ISLLE-1368

Terms of Arabic Origin in Azerbaijani Language, Borrowed From European Languages through Russian

Nadir Baloglan Oglu Memmedli | *National Academy of Sciences of Azerbaijan*

Mechanical Engineering/ Civil Engineering / Chemical Engineering (1)

Thursday, August 4 , 2016

10:30-12:15

守禮の間

(SHUREI no MA)

Session Chair: *Prof. Tomohiro Nakano*

APICENS-1414

Analysis of the Current Density Distribution in Patterned Mask Electrochemical Micro-Machining on the Invar Alloy Sheet: Applied Finite Element Method

Da-Som Jin | *Inha University*

Kwang-Ho Chun | *Inha University*

Eun-Sang Lee | *Inha University*

APICENS-1398

Development of Quaternized Polymer Based Ionomer Binder for On-Site Crosslinking at Energy Conversion Electrodes

Jin-Soo Park | *Sangmyung University*

Mun-Sik Shin | *Sangmyung University*

Hyoungh Juhn Kim | *Korea Institute of Science and Technology*

APICENS-1400

The Effect of Elevation Irregularity on Progressive Collapse Resistance of Multistory Reinforced Concrete Framed Structures under Gravity Loads

Mohamed El-Bayomy | *Cairo University*

Hamed Salem | *Cairo University*

APICENS-1433

Effect of Corrosion on Ductility of RC Columns

Ahmed Mohammed Youssef Mohammed | *Cairo University*

Ali Ahmed | *The University of Engineering and Technology Lahore*

Koichi Maekawa | *The University of Tokyo*

APICENS-1458

Evaluation of Inertial Force Effect of PC Rahmen Bridge under Various Fault Directions

Tomohiro Nakano | *Tokai University*

APICENS-1455

Comparisons on Thermal Stability of Quasi-Solid Electrolyte Samples Containing LiI for Grätzel-Type Solar Cells by TG and Coupled Methods of Evolved Gas Analysis

Viola Nagygyörgy | *Budapest University of Technology and Economics and Shizuoka University*

György Pokol | *Budapest University of Technology and Economics*

János Madarász | *Budapest University of Technology and Economics*

Elias Stathatos | *Technological-Educational Institute of Patras*

APICENS-1476

Biomimetic Surface Design and Fabrication for Eco-friendly Energy Saving Applications

Kijung Yong | *Pohang University of Science and Technology*

APICENS-1451

Design of Smart Walker for Gait and Balance Rehabilitation

Ahmad Muammar Bin Md Yasin | *Singapore Institute of Technology*

Lim Wei Liong | *Singapore Institute of Technology*

Dr. Patrick S.K.Chua | *Singapore Institute of Technology*

Zheng Jianxin | *Singapore Institute of Technology*

Education (3) / Linguistics (2) / Language (2)

Thursday, August 4, 2016 10:30-12:00

胡蝶の間

(KOCHO no MA)

Session Chair: *Tomoyasu Akiyama*

ISLLE-1311

Implementing Culturally Responsive Teaching in an Introductory Corpus Linguistics Course

Apay Ai-Yu Tang | *National Dong Hwa University*

ISLLE-1344

An Investigation of Rater Variability in the Context of Teacher Employment Examinations Using a Mixed Approach

Tomoyasu Akiyama | *Bunkyo University*

ISLLE-1340

Help Depressed College Students to Come out of Closet: Reduce Stigma Perceptions, Enhance Help-Seeking Communication

Ling-Hui Hsu | *Ming Chuan University*

ISLLE-1378

Oops, Being Handsome is So Awful! A Cognitive-Affective-Constructional Analysis of the Intensifier ‘can3le5’ in Taiwan Mandarin

Shumei Chiang | *Aletheia University*

ISLLE-1327

Court Sight Translation from Text-Linguistic Approach

Yaling Chen | *Aletheia University*

ISLLE-1335

We Have a Digital Story to Tell: Low-Achieving English Language Learners Found a Way to Express Themselves

Hsiao-Chien Lee | *National Kaohsiung Marine University*

Pei-Ling Wang | *National Kaohsiung University of Applied Sciences*

ISLLE-1365

**The Effect of Blending Instruction on Different Cognitive Style Students' English
Listening Comprehension**

Pei-Ling Wang | *National Kaohsiung University of Applied Sciences*

Hsiao-Chien Lee | *National Kaohsiung Marine University*

Material Science and Engineering / Chemical Engineering (2)

Thursday, August 4 , 2016

13:00-14:30

守禮の間

(SHUREI no MA)

Session Chair: *Prof. Yoshitake Nishi*

APICENS-1429

Remarkable Adhesion Improvement of Ti/Polymer Lamination Joints Irradiated by EB Prior to Hot-Press

Masataka Tomizawa | *Tokai University*

Michael C. Faudree | *Tokai University*

Arata Yagi | *Tokai University*

Itaru Jimbo | *Tokai University*

Yoshitake Nishi | *Tokai University*

APICENS-1430

Mechanical Properties of CFRP/Al Lamination Irradiated by Electron Beam Prior to Hot-Pressing

Daisuke Kitahara | *Tokai University*

Akiko Minegishi | *Tokai University*

Yoshihito Mastumura | *Tokai University*

Yoshitake Nishi | *Tokai University*

APICENS-1431

Attractive Surface Performances Induced by EB-Irradiation

Yoshitake Nishi | *Tokai University*

Michael Christopher Faudree | *Tokai University*

Ryuichiro Ohyama | *Tokai University*

Ryo Nomura | *Tokai University*

Anna Takahashi | *Tokai University*

Masae Kanda | *Chubu University*

Noriyuki Inoue | *Chubu University*

APICENS-1462

Development of Multilayer Ceramic Wireless Power Transfer Fabricated by Photo Resist Film Process

Minami Takato | *Nihon University*

Ken Saito | *Nihon University*

Fumio Uchikoba | *Nihon University*

IBCELC-28909

Synthesis and Properties of Poly(phenylene telluride) Obtained by Condensation Reaction of Tetrachlorotellurium and Triphenylmethane

Hiroto Kudo | *Kansai University*

Daisuke Inoue | *Kansai University*

IBCELC-28957

Expanding Scalability of Top-Down and Bottom-Up Nanofabrication

Wooyoung Shim | *Yonsei University*

Finance

Thursday, August 4 , 2016

13:00-14:30

胡蝶の間

(KOCHO no MA)

Session Chair: *Darius Chan*

ISBSS-5406

Multiple Large Shareholders, Corporate Risk Taking and Share Repurchases in China

Yi-Pei Chen | *Chung Yuan Christian University*

Tsui-Jung Lin | *Chinese Culture University*

Patumtip Wongsacharoensuk | *Chung Yuan Christian University*

ISBSS-5455

Mental Accounting and Personal Finance for Savings

Piyada Sombatwattana | *Srinakharinwirot University*

ISBSS-6076

The Efficiency of Internal Capital Markets and the Quality of Internal Accounting Information

Yong Zhang | *Hong Kong Polytechnic University*

ISBSS-6098

The Impact of Investors' Sentiment on Stock Price - Observations from Financing Strategy of Listed Companies in Taiwan

Hsin-Jung Hsieh | *Kainan University*

ISBSS-6108

Stopping Mandatory Financial Forecasts and Analyst Coverage: Evidence from Taiwan

Wann-Cherng Wang | *National Sun Yat-Sen University*

ISBSS-6065

Antecedents and Consequences of Acceptance of Wealth Inequality: Findings from a Territory-Wide Phone Survey in Hong Kong

Darius Chan | *The Chinese University of Hong Kong*

Grand Cheng | *Duke-NUS Graduate Medical School*

Dannii Yeung | *City University of Hong Kong*

Electrical and Electronic Engineering

Thursday, August 4 , 2016 14:45-16:15

守禮の間

(SHUREI no MA)

Session Chair: *Prof. Hung-Yuan Chung*

APICENS-1405

The Potential of Graphene Oxide to Passivate Si Solar Cells

Chu-Hsuan Lin | *National Dong Hwa University*

Guan-Yu Chen | *National Dong Hwa University*

Cheng-Ya Yu | *Taiwan Solar Energy Corporation*

Liang-Chun Chen | *National Dong Hwa University*

APICENS-1416

Nonlinear/Non-Gaussian Bayesian Tracking Algorithm Based on Cubature-Based Particle Filter

Chien-Hao Tseng | *National Chiao Tung University*

Dah-Jing Jwo | *National Taiwan Ocean University*

Sheng-Fuu Lin | *National Chiao Tung University*

APICENS-1450

The DTC of Permanent Magnet Synchronous Motor in Low Speed Condition Improvement Using Flux Compensator

Yi-Hao Jhu | *National Central University*

Hung-Yuan Chung | *National Central University*

Management

Thursday, August 4 , 2016

14:45-16:15

胡蝶の間

(KOCHO no MA)

Session Chair: *Peng-Ting Chen*

ISBSS-5429

The Hospitals' Big Data Implementation Resistance

Peng-Ting Chen | *National Cheng Kung University*

Ya-Ci Ke | *National Kaohsiung University of Applied Science*

Kuan-Chen Lee | *National Kaohsiung University of Applied Science*

Wan-Ning Wu | *National Sun Yat-sen University*

Chia-Li Lin | *Shih Chien University*

ISBSS-5436

The Impacts of Product Innovation and Value Chain Position upon Servitization-An Empirical Study from Taiwan CIS Survey

Bang-Ning Hwang | *National Yunlin University of Science and Technology*

Mu-Yen Hsu | *National Cheng-Chi University*

Tzu-Chi Chang | *National Yunlin University of Science and Technology*

ISBSS-6043

The Study of Car Selection in German via Grey Relational Grade

Yi-Chang Shen | *Chienkuo Technology University*

Yun-Chun Wang | *Chienkuo Technology University*

Wei-Chin Hung | *Chienkuo Technology University*

Tzu-Hao Lin | *YunTech*

Mei-Li You | *Chienkuo Technology University*

Kun-Li Wen | *Chienkuo Technology University*

ISBSS-6080

Organizational Identification, Organizational Commitment and the Employer's Word of Mouth (WOM) Intention

Luan-Ying Wei | *Takming University of Science and Technology*

Yun-Ying Lee | *Takming University of Science and Technology*

ISBSS-6103

A Study on Establishing Adaptive Solution to Relocated Sites in Daegu, Korea

Jin Choi | *Chonnam National University*

Woo-Hwa Shin | *Daegu Gyeongbuk Development Institute*

Xiaochen Zhang | *Chonnam National University*

Woo-Jin Shin | *Chonnam National University*

ISBSS-6989

Internal Marketing – A Pretence

Prakash Vel | *University of Wollongong in Dubai*

Aakash M Shah | *Independent Analyst*

Sunita Mathur | *Independent Market Analyst*

ISBSS-6102

Knowledge Sharing and Knowledge Creation in Enterprise the Viewpoint of “Empirical Knowledge”

Chengning Yang | *Nagoya University*

Business

Thursday, August 4 , 2016

16:30-17:30

胡蝶の間

(KOCHO no MA)

Session Chair: *Chia-Hui Huang*

ISBSS-6064

An Empirical Study Regarding the Satisfaction Level of Taiwanese Youth Tourists to Japan

Fumihiko Isada | *Kansai University*

Han-Ching Lin | *Chihlee University of Technology*

Yuriko Isada | *Kwansei Gakuin University*

ISBSS-5413

Big Data Classification with the Soft Margin Multi-Classifer Support Vector Machine

Chia-Hui Huang | *National Taipei University of Business*

Han-Ying Kao | *National Dong Hwa University*

ISBSS-5456

The Influence of a Restaurant's Social Contributions and Green Practices on Customers' Decision to Buy in a Chinese Context.

Choy Yip Hong, Sonny | *Technological and Higher Education Institute of Hong Kong*

ISBSS-6083

Framework for Studying the Perception of Alcohol Beverages Image and Alcohol Beverages Drinking Behavior of Thai Undergraduate Students

Shawanluck Kunathikornkit | *Srinakharinwirot University*

Piyada Sombatwattana | *Srinakharinwirot University*

Poster Session (1)

Biomedical Engineering / Biotechnology Engineering /

Chemical Engineering / Life Science

Wednesday, August 3 , 2016

13:40-14:40

守禮の間

(SHUREI no MA)

APICENS-1406

Analysis of Influenza A H3N2 HA Sequences Suggested the Vaccine Strains Circulated Several Years before They Were Administered in Taiwan

Guang-Wu Chen | *Chang Gung University*

Shu-Ming Kuo | *Chang Gung University*

Shin-Ru Shih | *Chang Gung University*

APICENS-1421

Enhancement of Osteogenic on Zn Release with Zn Doped DLC Film Coating

Junichi Katouno | *Tokyo Denki University*

Yasufumi Mabuchi | *Tokyo Denki University*

Yasuharu Ohgoe | *Tokyo Denki University*

Kenji Hirakuri | *Tokyo Denki University*

Kouki Fujioka | *Jikei University School of Medicine*

Yoshinobu Manome | *Jikei University School of Medicine*

Masanori Hiratsuka | *Nanotec Corporation*

Hitomi Tsuboi | *Nanotec Corporation*

Hideki Nakamori | *Nanotec Corporation*

Hideki Masuda | *NITI-ON Co, Ltd*

Hiroshi Honda | *NITI-ON Co, Ltd*

APICENS-1426

Amino Group Modification on DLC Coating to Medical Application

Kyoichi Terai | *Tokyo Denki University*

Yuta Murayama | *Tokyo Denki University*

Keisuke Sato | *Tokyo Denki University*

Kenji Hirakuri | *Tokyo Denki University*

Yasuharu Ohgoe | *Tokyo Denki University*

Jun Mizuno | *Waseda University*

Shuichi Shoji | *Waseda University*

IBCELC-28903

Monitoring Microbial Growth of Biodiesel Blends: Under Different Sulfur Concentrations and Biocide Applications

Jui-Hui Chen | *CPC Corporation, Taiwan*

Hsin-Yao Cheng | *CPC Corporation, Taiwan*

Chin-Chung Chen | *CPC Corporation, Taiwan*

Ai-Ling Kao | *CPC Corporation, Taiwan*

Chang-Ting Tsai | *CPC Corporation, Taiwan*

Zheng-Chia Tsai | *CPC Corporation, Taiwan*

IBCELC-28904

A Study on Optimal Operating Conditions for the Second-Generation Bioethanol Production by Co-Fermentation of Glucose and Xylose from Rice Straw

Chin-Chung Chen | *CPC Corporation, Taiwan*

Jui-Hui Chen | *CPC Corporation, Taiwan*

Hsin-Yao Cheng | *CPC Corporation, Taiwan*

Ai-Ling Kao | *CPC Corporation, Taiwan*

Chang-Ting Tsai | *CPC Corporation, Taiwan*

Zheng-Chia Tsai | *CPC Corporation, Taiwan*

Guo-Jhan Gao | *CPC Corporation, Taiwan*

IBCELC-28905

Conversion of Crude Glycerol, the Biodiesel Production By-Product, into Value-Add Chemical 2,3-Butanediol through Microbial Fermentation

Hsin-Yao Cheng | *CPC Corporation, Taiwan*

Chin-Chung Chen | *CPC Corporation, Taiwan*

Jui-Hui Chen | *CPC Corporation, Taiwan*

Ai-Ling Kao | *CPC Corporation, Taiwan*

Chang-Ting Tsai | *CPC Corporation, Taiwan*

Zheng-Chia Tsai | *CPC Corporation, Taiwan*

IBCELC-28926

Process Simulation for Advanced Bioethanol Production from Nipa Sap through Acetic Acid Fermentation

Dung Van Nguyen | *Kyoto University*

Harifara Rabemanolontsoa | *Kyoto University*

Eiji Minami | *Kyoto University*

Haruo Kawamoto | *Kyoto University*

Shiro Saka | *Kyoto University*

Pinthep Sethapokin

IBCELC-28947

Efficient Conversion of Lignocellulosic Hydrolyzates to Acetic Acid by Co-Immobilized *Clostridium thermocellum* and *Moorella thermoacetica* (*C. thermoaceticum*)

Harifara Rabemanolontsoa | *Kyoto University*

Piradee Jusakulvijit | *Kyoto University*

Shiro Saka | *Kyoto University*

IBCELC-28895

Recycle Photothermal Effect of Fe₃O₄ and WO₃ Immobilized Montmorillonite Nanocomposites

Mazrad Zihnil Adha Islamy | *Korea National University of Transportation*

Young Kwang Kim | *Korea National University of Transportation*

Choi Mina | *Korea National University of Transportation*

Sung Young Park | *Korea National University of Transportation*

IBCELC-28906

Nanoporous Silica Aerogel Membranes for CO₂ Capture

Yi-Feng Lin | *Chung Yuan Christian University*

IBCELC-28941

Development of Colorimetric Sensor for Toxic Gas Detection Using Electrospun Thin Film

Seung Kyun Yoon | *Sungkyunkwan University*

Sung Yeol Kim | *Sungkyunkwan University*

Jungho Ahn | *Sungkyunkwan University*

Dong June Chung | *Sungkyunkwan University*

IBCELC-28951

Biomimetic Self-Assembly of Porphyrin-Conjugated Polyaspartamide for Molecular Ultrasound Imaging

Jae Hyun Jeong | *Soongsil University*

Yoonna Cho | *Soongsil University*

Hee Jin Kim | *Soongsil University*

Sung Woo Cho | *Soongsil University*

Shin Sung Gyu | *Soongsil University*

IBCELC-28889

Generation of the Enterotoxigenic Escherichia Coli Ghost Vaccine Candidate by GI24 and Its Protection Efficacy against Neonatal Piglet Colibacillosis

Won Kyong Kim | *Chonbuk National University*

Ja Young Moon | *Chonbuk National University*

Jin Hur | *Chonbuk National University*

IBCELC-28894

Interaction of Anesthetic Agents with Neuro-Active Indoleamine-Aldehyde Condensation Products

Hironori Tsuchiya | *Asahi University*

Maki Mizogami | *University of Fukui*

IBCELC-28900

Hernandezine, a Bisbenzylisoquinoline Alkaloid with Inhibitory Activity against Multidrug Resistance-Linked ATP-Binding Cassette Drug Transporter ABCB1

Chung-Pu Wu | *Chang Gung University*

Sung-Han Hsiao | *Chang Gung University*

IBCELC-28918

Predicting Oncogenes of Hepatocyte Using Genome-Scale Metabolic Model

Meng-Chun Chen | *National Chung Cheng University*

Wen-Huan Liu | *National Chung Cheng University*

Feng-Sheng Wang | *National Chung Cheng University*

IBCELC-28922

Heterologous Expression and Functional Characterization of the dTDP-2-Deoxyfucose

Biosynthetic Enzymes

Hsien-Tai Chiu | *National Cheng Kung University*

Chien-Pao Weng | *National Cheng Kung University*

Poster Session (2)

Civil Engineering / Computer and Information Sciences /

Electrical and Electronic Engineering / Material Science and

Engineering / Business / Economics / Finance / Management

Wednesday, August 3 , 2016

15:00-16:00

守禮の間

(SHUREI no MA)

APICENS-1457

Estimation of Alien Subject Location in Concrete Slab Using Linear Travel Interpolation Method

Hiromasa Kimata | *Daido University*

Tomohiro Nakano | *Tokai University*

APICENS-1464

Analysis of Debris Flow Run-out and Risk Computation According to Initial Mass Distributions and Defensive Structure Types

Seung Myeong Oh | *Incheon National University*

Chang Geun Song | *Incheon National University*

Hyun Ju Jang | *Incheon National University*

APICENS-1460

Pseudo High Resolution Picture Generation Based on a Patch Library

Yuji Saito | *Kokushikan University*

Shinya Nakajima | *Kokushikan University*

APICENS-1472

Novel Mobility Management based Context Awareness Networks

Seungyong Shin | *Hannam University*

Byungjoo Park | *Hannam University*

APICENS-1393

Investigating Guided-Modes for Tilted Fiber Bragg Grating by Using Finite Element Method

Yue-Jing He | *National Chin-Yi University of Technology*

Wei-Chih Hung | *National Chin-Yi University of Technology*

APICENS-1459

VLSI Implementation of 8051 MCU with Decoupling Capacitor for IC-EMC

Pei-Jung Tsai | *National Taiwan Ocean University*

Mao-Hsu Yen | *National Taiwan Ocean University*

Yeong-Chang Maa | *National Taiwan Ocean University*

Chiu-Kuo Chen | *Ministry of Economic Affairs, R.O.C.*

Yen-Tang Chang | *Ministry of Economic Affairs, R.O.C.*

Ming-Yan Shyu | *National Taiwan Ocean University*

Shu-Ping Zheng | *National Taiwan Ocean University*

APICENS-1404

Cost-Effective α -Fe₂O₃ Photocatalyst for Green Applications

Chih-Ming Wang | *National Dong Hwa University*

APICENS-1424

Magnetic and fluorescence properties of Ammonium Silicon Fluoride/Iron Oxide Composite Microparticles

Masaya Kudo | *Tokyo Denki University*

Keisuke Sato | *Tokyo Denki University*

Kenji Hirakuri | *Tokyo Denki University*

APICENS-1425

Multi-Color Fluorescence of (NH₄)₂SiF₆/POx Composite Microparticles

Masayuki Suzuki | *Tokyo Denki University*

Keisuke Sato | *Tokyo Denki University*

Kenji Hirakuri | *Tokyo Denki University*

APICENS-1427

The Effect of Ar Addition on the Structural and Tribological Properties of Nanodiamond Films Grown by MPCVD

Jong Cheon Park | *Pusan National University*

Byoung Su Choi | *Pusan National University*

Jin Kon Kim | *Pusan National University*

Sungu Hwang | *Pusan National University*

Hyun Cho | *Pusan National University*

ISBSS-5421

A Stochastic Programming Model to Solve the Capacity Expansion Problem Considering Auxiliary Tools: A Semiconductor Foundry Case

Yin-Yann Chen | *National Formosa University*

ISBSS-6074

Passenger Demand Model for Airport-Pairs Routes within Dual-Airport System

Chih-Wen Yang | *National Taichung University of Science and Technology*

ISBSS-5284

The Effect of Information Disclosure on Adoption of Coercive Regulation: U. S. Renewable Energy Policies on Electric Utilities

Hyunhoe Bae | *Yonsei University*

Sanguk Yu | *Yonsei University*

ISBSS-5467

The Study about Price Premiums of Sale-Leaseback in Real Estate Markets

Chin-Ming Chen | *National Kaohsiung First University of Science and Technology*

ISBSS-6046

A Structural Analysis of Housing Value

Ming-Chi Chen | *National Chengchi University*

Chih-Hsing Hung | *National Kaohsiung First University of Science and Technology*

ISBSS-6075

The Asymmetry Trading Behavior of Mutual Fund Investors in Taiwan

Nan-Yu Wang | *Ta Hwa University of Science and Technology*

Sen-Sung Chen | *Feng-Chia University*

Chih-Jen Huang | *Providence University*

Shih-Heng Hsiao | *Feng-Chia University*

ISBSS-6077

**The Trading Behavior of Stock Investors under Different Trading Mechanisms –
Evidences from Vietnam HoChiMinh Stock Exchanges and Hanoi Stock Exchanges**

Ming-Chun Wang | *National Kaohsiung First University of Science and Technology*

ISBSS-5470

**Brand Evangelism Effects on Facebook Fan Pages: An Integrated Perspective of
Self-Congruity and Social Identify Theory**

Li-Chun Hsu | *National Taitung University*

ISBSS-6047

**Contribution of Japanese Management Accounting on the Research: A Bibliographic
Study on English Journals**

Keita Iwasawa | *Keio University*

Eisuke Yoshida | *Keio University*

Poster Session (3)

Communication / Education / Sociology / Psychology / Politics

Wednesday, August 3, 2016

16:20-17:20

守禮の間

(SHUREI no MA)

ISBSS-6091

A Study on the Influences of the Third-Person Effect According to the Type of Emotional Response to Advertising of Digital Products

Younho Kim | *Pukyong National University*

Changhoon Park | *Gabs&D Company*

Chunggun Jang | *Pukyong National University*

ISBSS-6958

Analyzing the Determinant of Risk Perception about MERCI

Seoyong Kim | *Ajou University*

Sunhee Kim | *Seowon University*

ISBSS-6967

Explore the Impact of Satirical User-Generated Content in 2016 Taiwanese Presidential Election

Chi Ying Chen | *Asia University*

Man Ting Pan | *Asia University*

ISBSS-6969

LINE Communication in the 2016 Taiwanese Presidential Election

Chi Ying Chen | *Asia University*

Tang Wei Lin | *Asia University*

ISBSS-6971

Strategies to Structure the Facebook Messages during the 2016 Taiwanese Presidential Election

Chi Ying Chen | *Asia University*

Hsin Yen Lin | *Asia University*

ISLLE-1351

Development of Physical Computing Curriculum Using Android Devices and S4A

Tae-Woo Kim | *Seoul National University of Education*

Seok-Ju Chun | *Seoul National University of Education*

ISLLE-1350

Development Worksheets in Scratch Programming Education for Elementary School Students

Minho Jang | *Seoul National University of Education*

ISLLE-1326

A Study on the Instructional Design of Software Education Based on Backward Design Model

Youngho Lee | *Seoul National University of Education*

Dukhoi Koo | *Seoul National University of Education*

ISLLE-1359

Visual Awareness Performance in Reading Texts on Paper versus Tablet in Indonesian Elementary School Students

Siti Dian Mardiyani | *University of Tsukuba*

Toshiharu Enomae | *University of Tsukuba*

ISLLE-1356

An Evaluative Study on the Feasibility of “Primer Design for PCR” as a Lesson in High School Biology Curriculum

Yang-Tsung Chung | *National Chung Hsing University*

Su-Ling Hwang | *National Chung Hsing University*

ISLLE-1328

Teaching Science Text to Elementary School EFL Learners

Yueh-Nu Hung | *National Taichung University of Education*

Pin-Hsuan Lin | *Hsin-Hsiang Elementary School*

Shih-Chieh Liao | *China Medical University*

ISBSS-6057

Interpretation of Interior Design Education Refer to the Process of Hotel Design

Tsann-Chung Wu | *Chung Yuan Christian University*

ISBSS-6116

Determination of Reading Level by Comparing Results of an Online Placement Test, Standardized Tests and Student Deduction

Kurt William Ackermann | *Hokusei Gakuen University Junior College*

ISBSS-6099

Study of the Postures which Cause Physical Strain to the Elderly Care Workers

Hiroaki Fujii | *Fukuyama Heisei University*

Mai Fukushina | *Special Elderly Nursing Home "Honobono-en"*

Yuki Ujihara | *Fukuyama Heisei University*

ISBSS-6982

Lessons Learned from the Philosophy of Sufficiency Economic Used for Environmental Management in Bangnamphueng Community, Phrapadaeng District, Samutprakan Province, Thailand

Kallyanee Kullachai | *Srinakarinwirot University*

ISBSS-6960

Components of Comfort in Residential Space

Shih-Yung Liu | *Chung Yuan Christian University*

Yi-Ching Liu | *Tungnan University*

ISBSS-6073

Regarding the Efficacy of "Providing Information Relating to Nursing" through the Use of Free Informative Magazines

Taizo Ito | *Fukuyama Heisei University*

Yuki Ujihara | *Fukuyama Heisei University*

